

wissmann  
raumobjekte



Multimedia

SUSTAINABLE PRODUCTS • TIMELESS QUALITY

Made  
in  
Germany



## TV HOLDER SOLUTION ART123

As in all models of our solution range, the art123 TV holder can also be swiveled into any desired position, thus affording an optimum view from anywhere in the room.

The cable routing is concealed in the anchoring pivotal column.

### FEATURES AND BENEFITS

- > swivel arm in different lengths up to 87 cm (select according to TV width)
- > high-quality bearings allow stable rotation (TV 90° to the wall)
- > small wall-clearance in parkposition (approx. 50 mm)
- > high-quality and sustainable materials ensure maximum quality
- > design and production "Handmade in Germany" with an everlasting lifespan
- > high-quality and durable powder coating (extension arm)
- > hidden cable management (invisible inside the arm and the column)

### DIMENSIONS

- > size 1: For TV screens up to 55" (up to 55 kg): 54 cm swivel arm; max. wall clearance 58 cm; height 142 cm, screen middle 100 cm
- > size 2: For TV screens up to 65" (up to 55 kg): 67 cm swivel arm; max. wall clearance 71 cm; height 150 cm, screen middle 108 cm
- > size 3: for TV screens up to 85" (up to 80 kg): 87 cm swivel arm; height, 170 cm; max. wall clearance 91 cm, screen middle 120 cm
- > for TV installation VESA 100 to 600 mm

### MATERIAL

- > swivel arm: steel with stove-enamel finish (powder coating, black)
- > anchoring pivotal column finely brushed stainless steel

### OPTIONS

- > additional RAL color for anchoring pivotal column and/or swivel arm
- > overall height to customer specification
- > mount for soundbar or center speaker
- > AV-board (to swivel with the TV)





## TV HOLDER SOLUTION ART121

TV holder art121 allows you to swivel the television into any angle providing optimum view from anywhere in the room. Special feature: concealed cable management. In the park position, the model art121's anchoring pivotal column stand will always be positioned on the left hand side.



### FEATURES AND BENEFITS

- > swivel arm in different lengths up to 85 cm (select according to TV width)
- > high-quality bearings allow stable rotation (TV 90° to the wall)
- > small wall-clearance in parkposition (approx. 60 mm)
- > high-quality and sustainable materials ensure maximum quality
- > design and production "Handmade in Germany" with an everlasting lifespan
- > high-quality and durable powder coating
- > hidden cable management (invisible inside the arm and the column)

### DIMENSIONS

- > size 1: for TV screens up to 55" (up to 50 kg): 52 cm swivel arm; height 144 cm; max. wall clearance 56 cm; screen middle 100 cm
- > size 2: for TV screens up to 65" (up to 50 kg): 65 cm swivel arm; height, 144 cm; max. wall clearance 69 cm, screen middle 100 cm
- > size 3: for TV screens up to 85" (up to 80 kg): 85 cm swivel arm; height, 170 cm; max. wall clearance 89 cm, screen middle 125 cm
- > for TV installation VESA 100 to 600 mm

### MATERIAL

- > powdercoated steel with fine textured finish, in matt black, white or silvergrey
- > swivel element (backside) in stainless steel

### OPTIONS

- > additional RAL colors
- > overall height to customer specification
- > mount for soundbar or center speaker
- > AV board



## TV HOLDER SOLUTION ART112

The functional design embodied in our solution range enables the TV screen to be mounted in such a manner as to hang very flat against the wall, and to be capable of being swiveled into any desired position, thus affording you a perfect view of the screen from anyplace in the room. Special feature: concealed cable management.

### FEATURES AND BENEFITS

- > swivel arm in different lengths up to 99 cm (select according to TV width)
- > high-quality bearings allow stable rotation (355° and TV 90° to the wall)
- > high-quality and sustainable materials ensure maximum quality
- > design and production "Handmade in Germany" with an everlasting lifespan
- > high-quality and durable powder coating (extension arm)
- > hidden cable management (invisible inside the arm and the column)

### DIMENSIONS

- > size 1: TV screens up to approx. 55" (up to 50 kg)  
80 cm between horizontal cross struts; 64 cm swivel arm; height 151 cm, max. wall clearance 82 cm
- > size 2: TV screens up to approx. 65" (up to 60 kg)  
88 cm between horizontal cross struts; 73 cm swivel arm; height 158 cm, max. wall clearance 89 cm
- > size 3: TV screens up to approx. 75" (60 kg)  
102 cm between horizontal cross struts; 84 cm swivel arm; height 173 cm, max. wall clearance 93 cm
- > size 4: TV screens up to approx. 85" (up to 85 kg)  
122 cm between horizontal cross struts; 99 cm swivel arm; height 195 cm, max. wall clearance 115 cm
- > overall width: width of TV + 12 cm (4,7")
- > center of TV screen from floor approx. 100 cm (size 1), 104 cm (size 2), 110 cm (size 3), 120 cm (size 4)
- > for TV installation VESA 100 to 600

### MATERIAL

- > finely brushed stainless steel
- > regular steel, powder-coated

### OPTIONS

- > AV board in 2 different sizes
- > cross struts and AV board in a different RAL color
- > overall height to customer specification
- > mount for soundbar or center speaker (swiveling with the TV)
- > wall mount for corner mounting





> art128-1



> art128-NA



## TV HOLDER SOLUTION ART128-1 AND ART128-NA

Full swivel range for best angle of view (depending on the width of TV set) concealed cable management.  
Same functionality as our art123 but the vertical column in angular design (9,5 x 4 cm)

### FEATURES AND BENEFITS

- > high-quality bearings allow stable rotation (TV 90° to the wall)
- > small wall-clearance in parkposition (approx. 45 mm)
- > high-quality and sustainable materials ensure maximum quality
- > design and production "Handmade in Germany" with an everlasting lifespan
- > high-quality and durable powder coating (extension arm)
- > hidden cable management (invisible inside the arm and the column)

### DIMENSIONS

- > size 1: For TV screens from 40" to 55" (up to 30 kg): 55 cm swivel arm; max. wall clearance 58 cm; height 142 cm  
center of TV screen approx. 100 cm from the floor
- > size 1-NA: TV from 40" to 55" (up to 30 kg): swivel arm 55 cm; max. wall clearance 58 cm; without vertical column (wallmount in stainless steel)
- > size 2-NA-65: TV from 55" to 65" (up to 25 kg): swivel arm 67 cm; max. wall clearance 71 cm; without vertical column (wallmount in stainless steel)
- > for TV installation VESA 100 to 600 mm

### MATERIAL

- > swivel arm: steel powder coating, black
- > anchoring pivotal column finely brushed stainless steel

### OPTIONS

- > additional RAL colors for the column
- > overall height to customer specification
- > mount for soundbar or center speaker
- > AV board



LESS IS MORE





> 1-axes



> 2-axes



## TV HOLDER POST ART129

In this model, a stainless steel anchoring pivotal column provides the basis for a swiveling TV holder with concealed cable management. A TV set thus mounted can either be turned on the anchoring pivotal column (1 axes, up to 50 kg) or swiveled around it using the extendable arm (2 axes of motion, up to 35 kg). For TV screens from 40" to 85". (for different TV sizes upon request)

### FEATURES AND BENEFITS

- > swivel arm in different lengths up to 120 cm (select according to TV width)
- > high-quality bearings allow stable rotation (TV 90° to the wall)
- > high-quality and sustainable materials ensure maximum quality
- > design and production "Handmade in Germany" with an everlasting lifespan
- > high-quality and durable powder coating (extension arm)
- > hidden cable management (invisible inside the arm and the column)

### DIMENSIONS

- > diameter of anchoring pivotal column; 6 cm (2,4")
- > for use up to a ceiling clearance of 330 cm or on request (129,9")
- > swivel arm (version with 2 axes of motion) 52 cm (20,5")
- > AV shelf: 47 x 40 cm (18,5" x 15,7")

### MATERIAL

- > column in finely brushed stainless steel
- > steel with stove-enamel finish (powder coating, black)

### OPTIONS

- > additional RAL colors for the swivel arm
- > swivel arm up to 120 cm
- > column for up to 600 cm room height
- > AV shelf 47 x 40 cm (up to 3 units)
- > mount for soundbar or centerspeaker
- > cables entrance from the upside or from the downside

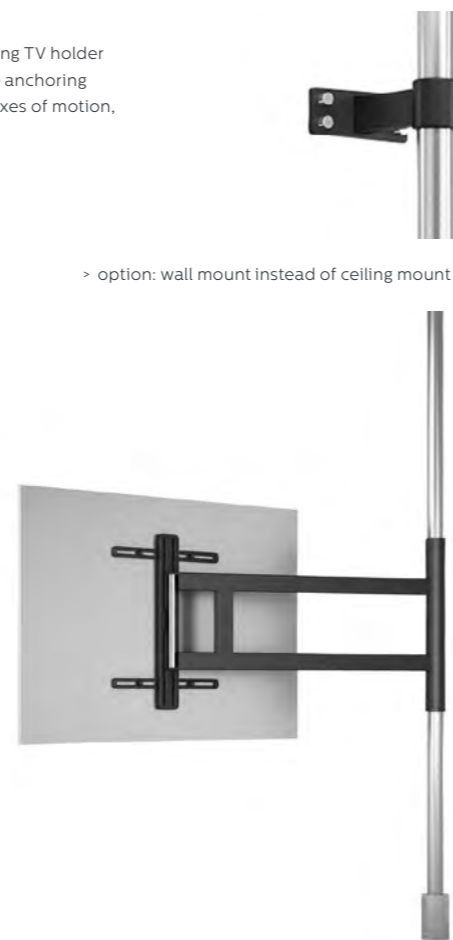

> option: wall mount instead of ceiling mount

> option: double arm in desired length for large or heavy TV sets



> 1-axes > 2-axes

TIMELESS DESIGN





## TV HOLDER COLUMN ART118-ES / -S / -H

The TV holder art118 is like a piece of jewelry for your TV.  
The striking simplicity of this design will win you over!  
For TV screens from 40" to 75" (up to 55 kg).

### FEATURES AND BENEFITS

- > very stable stand
- > smooth-running soft casters
- > high-quality and sustainable materials ensure maximum quality
- > design and production "Handmade in Germany" with an everlasting lifespan
- > hidden cable management (invisible inside the column and base)

### DIMENSIONS (H X W X D)

- > column in stainless steel: 136 cm (53.5 inches) D 9 cm (3.6 inches)
- > column in steel: 136 x 14 x 4 cm
- > column in wood finish 143 x 15 x 7 cm
- > stainless steel base: 3 x 68 x 41 cm (1.2 x 26.8 x 16.1 inches)
- > center of screen approx. 100 cm (from floor)
- > for TV installation VESA 100 to 400 (600 mm on request)

### MATERIAL

- > column in finely brushed stainless steel
- > column in steel powdercoated; a finely textured matt black finish
- > column in wood available in a selection of veneers
- > base in finely brushed stainless steel

### OPTIONS

- > various RAL colors
- > a selection of wood veneers
- > mount for sound bar system or center speaker
- > AV-board

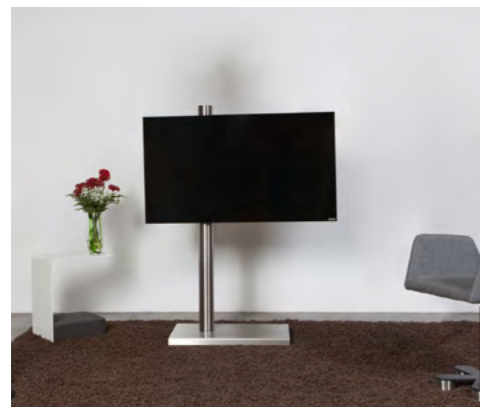

> art 118-h (column in wood)



> art 118-s





> art 111-r



> art 111-e

## TV HOLDER OMEGA ART111-R UND ART111-E

Less is more: this engagingly minimalist TV holder as a free-standing model is distinctive for its clean lines.

Integrated concealed casters are available upon request.

Height of center of TV screen approx. 100 cm (from floor)

### FEATURES AND BENEFITS

- > very stable stand
- > smooth-running casters (option)
- > high-quality and sustainable materials ensure maximum quality
- > design and production "Handmade in Germany" with an everlasting lifespan
- > high-quality and durable powder coating
- > hidden cable management invisible inside the column

### DIMENSIONS

- > column: 4 x 14 cm
- > size 1 circular: diameter of 58 cm (for TV from 40" to 60", 60 kg)
- > size 2 circular: diameter of 70 cm (for TV up to 75", 70 kg)
- > size 1 rectangular: 1 x 58 x 45 cm (h x w x d), (for TV from 40" to 60", 60 kg)
- > size 3 rectangular: 1 x 125 x 60 cm (h x w x d), (TV up to 85", 85 kg)
- > for TV installation VESA 100 to 400 (600 mm on request)



### MATERIAL

- > painted steel with fine textured finish, in matt black, white or silvergrey
- > finely brushed stainless steel (for optional casters)

### OPTIONS

- > various RAL colors
- > mount for sound bar system or center speaker
- > AV-board
- > concealed casters in stainless steel covers

> art 111-e-3





## TV HOLDER INDIVIDUAL ART110

TV holder as free-standing version for flat-screens from 40" bis 70".  
Concealed storage space in the vertical column for cables and multiple sockets.

### FEATURES AND BENEFITS

- > very stable stand
- > smooth-running soft rubber casters (option)
- > high-quality and sustainable materials ensure maximum quality
- > design and manufacture "Handmade in Germany" with an everlasting lifespan
- > high-quality and durable powder coating (extension arm)
- > hidden cable management (invisible in arm, column and base)

### DIMENSIONS (H X W X D)

- > size 1: for TV screens from 40" to 55": height, 135 cm (arm length 63 cm)
- > size 2: for TV screens to 70": height 150 cm (arm length 74 cm)
- > base 16 x 72 x 36 cm (5,9" x 28,3" x 14,2")
- > for TV installation VESA 100 to 400 (600 mm on request)

### MATERIAL

- > finely brushed stainless steel
- > base with slate-effect finish

### OPTIONS

- > mount for sound bar or center speaker
- > AV board
- > concealed casters
- > function to rotate the TV
- > base backside open for devices (8 x 45 x 30 cm)



## TV HOLDERTWIN ART114

Concealed cable management. Integrated concealed casters upon request.

### FEATURES AND BENEFITS

- > very stable stand
- > smooth-running soft rubber casters (option)
- > high-quality and sustainable materials ensure maximum quality
- > design and production "Handmade in Germany" with an everlasting lifespan
- > hidden cable management invisible inside the column

### DIMENSIONS (H X W X D)

- > size 1: for TV 40" to 65" (up to 45 kg): Base 10 x 100 x 18 cm (3,9" x 39,4" x 7")
- > size 2: for TV up to 75" (up to 75 kg): Base 10 x 135 x 18 cm (3,9" x 53,1" x 7")
- > size 3: for TV up to 85" (up to 85 kg): Base 10 x 180 x 18 cm (3,9" x 70,9" x 7")
- > center of TV screen: 100 cm or 39,4" (size 1) and 120 cm (size 3) (from floor)
- > for TV installation VESA 100 to 400 (600 mm on request)

### MATERIAL

- > finely brushed stainless steel
- > base with slate-effect finish

### OPTIONS

- > base in wood or in slate-effect finish
- > mount for sound bar or center speaker
- > AV board
- > base cabinet in wood or painted (RAL) to customer specification
- > breadth of base 35 (13,8") instead of 18 cm (7")
- > concealed casters



## TV STAND LIGHT ART147

Keep it simple: our smallest TV-stand  
 Invisible cable management in the column.  
 Height of center of TV screen approx. 90 cm (from floor)  
 For TV up to 60", up to 20 kg

### FEATURES AND BENEFITS

- > very stable stand
- > high-quality and sustainable materials ensure maximum quality
- > design and production "Handmade in Germany" with an everlasting lifespan
- > high-quality and durable powder coating
- > hidden cable management invisible inside the column

### DIMENSIONS (H X W X D)

- > column: 3 x 3,5 cm
- > base diameter 50 cm
- > for TV installation VESA 100 to 400 (600 mm on request)

### MATERIAL

- > painted steel with fine textured finish, in matt black, white or silvergrey

### OPTIONS

- > various RAL colors
- > mount for sound bar system or center speaker
- > AV-board

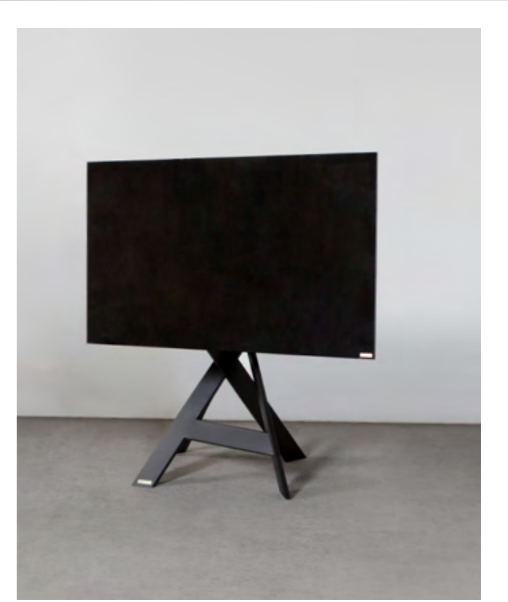

## TV STAND FLAT ART135

At last! A holder for small TV sets!  
 With concealed casters to allow smooth and easy travel and concealed cable management.  
 For TV screens from 32" to 55" (up to 30 kg)

### FEATURES AND BENEFITS

- > very stable stand
- > smooth-running soft casters
- > high-quality and sustainable materials ensure maximum quality
- > design and production "Handmade in Germany"
- > hidden cable management (backside the column and base)

### DIMENSIONS (H X W X D)

- > vertical panel: 115 x 40 x 3 cm
- > base in stainless steel: 3 x 68 x 41 cm
- > center of TV screen approx. 95 cm (from floor)
- > for TV installation VESA 100 to 400 (600 mm on request)

### MATERIAL

- > panel: wood finish or silk-matt painted surface (white, black, anthracite grey)
- > base in finely brushed stainless steel

### OPTIONS

- > various RAL colors
- > mount for sound bar system or center speaker
- > AV-board



## TV STAND MIKADO ART113

Only four legs and yet extraordinary!  
 Your TV becomes an objet d'art in your living room.  
 The cables are hidden in the rear leg  
 Bottom edge of TV stands approx. 53 cm (16.9 inches)  
 For 40" to 65" TVs (up to 55 kg; 121 lbs.)  
 with Vesa wall mounts 100 to 400 (also available up to 600).

### FEATURES AND BENEFITS

- > very stable stand
- > high-quality and sustainable materials ensure maximum quality
- > design and production "Handmade in Germany" with an everlasting lifespan
- > high-quality and durable powder coating
- > hidden cable management

### DIMENSIONS (H X W X D)

- > 56 (+TV height) x 55 x 50 cm
- > for TV installation VESA 100 to 400 (600 mm on request)

### MATERIAL

- > painted steel with fine texture in matte black, white, or silvergrey
- > for TV installation: stainless steel column

### OPTIONS

- > various RAL colors
- > mounts for sound bar or center speaker
- > TV can be rotated 360°





## TV HOLDER MOVE ART115

Through its substantial weight the art115's pedestal guarantees a high degree of stability. Its elegantly simple lines give it a light and airy design, which serves as a perfect setting for any flat-screen TV set. Concealed storage space in the pedestal for cables and multiple sockets. Concealed casters allow smooth travel. Concealed cable management. For TV 37" to 65" (up to 45 kg)

### FEATURES AND BENEFITS

- > very stable stand
- > smooth-running casters (option)
- > high-quality and sustainable materials ensure maximum quality
- > design and production "Handmade in Germany"
- > hidden cable management invisible inside a backside cablecover

### DIMENSIONS (H X W X D)

- > total 130 x 70 x 42 cm (51,2" x 27,6" x 16,5")
- > pedestal 19 x 50 x 42 cm (7,5" x 19,7" x 16,5")
- > distance between pedestal and panel: 16 cm (6,3")
- > center of TV screen: approx. 90 - 110 cm or 39,4" (from floor)
- > for TV installation VESA 100 to 400 (600 mm on request)

### MATERIAL

- > real wood veneer or
- > painted surface (RAL), black, white, dark grey

### OPTIONS

- > additional RAL colors
- > various types of wood veneer
- > holder for Sound Bar or center speaker



## TV HOLDER MOVE ART125

As in our move art115 model, concealed casters allow smooth and easy travel. Concealed cable management. For TV 40" to 65" (up to 50 kg)

### FEATURES AND BENEFITS

- > very stable stand
- > smooth-running soft casters
- > high-quality and sustainable materials ensure maximum quality
- > design and production "Handmade in Germany" with an everlasting lifespan
- > high-quality and durable powder coating
- > hidden cable management (invisible inside the column and base)

### DIMENSIONS (H X W X D)

- > base: 22 x 55 x 40 cm (8,7" x 21,7" x 15,7")
- > shelf height: 15 cm (5,9")
- > center of TV screen: approx. 100 cm or 39,4" (from floor)
- > for TV installation VESA 100 to 400 (600 mm on request)

### MATERIAL

- > powdercoated steel with fine textured finish, in matt black, white or silvergrey

### OPTIONS

- > mount for sound bar or center speaker
- > color to customer specification (RAL)

Details at [www.wissmann-raumobjekte.de](http://www.wissmann-raumobjekte.de)

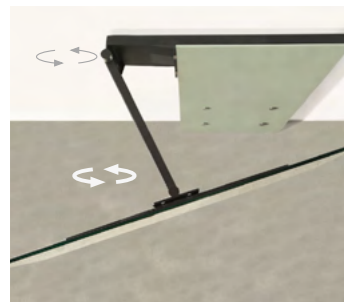

### TV HOLDER PLATE ART117

High-quality shelf board made of wood, glass plate with painted reverse side or in slate-effect finish to support the television set. Concealed routing for all cables. As with the other models of the solution range, the TV can be swiveled in all directions. For TV screens from 42" to 65" (up to 45 kg) (min. width of the TV is 110 cm (43"))

#### DIMENSIONS

- > shelf board: 118 x 55 cm (46,5" x 22")
- > wall clearance backside of the plate: 3 cm (1,2")
- > length of the swivelarm: 50 cm
- > max. wall clearance: 62 cm (24,4")
- > max. plate clearance: 54 cm (21,3")
- > center of TV screen: approx. 100 cm or 39,4" (from floor)

#### MATERIAL

- > shelf board of wood or plate glass, in slate-effect or painted finish

#### OPTIONS

- > various RAL colors
- > swivel arm to the left or to the right
- > AV board left or right side of the plate
- > or AV board below the TV to be swiveled
- > mount for soundbar or center speaker allowed to swivel with the TV
- > shelf board in different types of wood; glass plate or slate-effect finish



### TV HOLDER PLATE ART126

This model features concealed routing for all cables. As with the other TV holders of the solution range, it is possible to swivel the TV set in all directions. For TV screens from 42" to 65" (of up to 35 kg and a minimum flat screen width of 110 cm)

#### FEATURES AND BENEFITS

- > high-quality bearings allow stable rotation
- > high-quality and sustainable materials ensure maximum quality
- > design and production "Handmade in Germany" with an everlasting lifespan
- > high-quality and durable powder coating (extension arm)
- > hidden cable management

#### DIMENSIONS (H X W X D)

- > panel: 100 cm x 45 x 4 cm
- > length of swivelarm: 47 cm
- > center of TV screen: approx. 100 cm (from floor)
- > max. clearance of TV set to wall: 55 cm
- > max. clearance of TV set to panel: 51 cm
- > for TV installation VESA 100 to 400 (600 mm on request)

#### MATERIAL

- > powdercoated steel with fine textured finish, in matt black, white or silvergrey

#### OPTIONS

- > various RAL colors
- > AV Board on the side (permanently installed) or under TV (can be swiveled)
- > mount for sound bar system or center speaker (swiveling with the TV)
- > panel above TV screen stretches up to the ceiling



> plate art 126

> plate art 126 ceiling-high





### TV HOLDER TRIPOD ART130

Creative customers look for creative products.  
 How to give your TV set an artistically appealing setting:  
 Let the photos work their charm...  
 Concealed in the posterior stand, the cables are routed downwards.  
 For TV screens from 40" to 70". (max. TV height 85 cm, up to 50 kg)

#### FEATURES AND BENEFITS

- > very stable stand
- > high-quality and sustainable materials ensure maximum quality
- > design and production "Handmade in Germany" with an everlasting lifespan
- > hidden cable management (invisible inside the backside column)

#### DIMENSIONS

- > total height: 176 cm (69,3")
- > center of TV screen: approx. 100 cm or 39,4" (from floor)
- > distance between legs: 85 cm (33,5")
- > diameter of leg: 4 cm (1,6")
- > for TV installation VESA 100 to 400 (600 mm on request)

#### MATERIAL

- > powder-coated steel (black texture paint)
- > legs in finely brushed stainless steel

#### OPTIONS

- > mount for sound bar or center speaker
- > AV Board
- > color to customer specification (RAL)



### TV STAND BALANCE ART131

This exceptional, multidirectionally versatile wonder of a holder, not only enables you to swivel your TV quite freely, but also to rotate it and adjust its height from the floor. There is no more exceedingly functional and impressive fashion to mount your TV set. With concealed cable management.  
 Height of center of TV screen approx. 100 cm (from floor; adjustable)

#### FEATURES AND BENEFITS

- > very stable stand
- > high-quality bearings allow stable rotation
- > high-quality and sustainable materials ensure maximum quality
- > design and production "Handmade in Germany" with an everlasting lifespan
- > high-quality and durable powder coating
- > hidden cable management (invisible inside the arm and the column)

#### DIMENSIONS (H X W X D)

- > column: 122 x 4 x 14 cm
- > base: diameter of 55 cm
- > for TV sets 40" to 65" (up to 30 kg and screen widths of up to 160 cm)
- > arm: 100 cm + 75 cm
- > for TV installation VESA 100 to 400 (600 mm on request)

#### MATERIAL

- > powder coated steel with fine textured finish, in matt black, white or silvergrey
- > finely brushed stainless steel

#### OPTIONS

- > various RAL colors
- > mount for sound bar system or center speaker
- > AV-board





## TV STAND ARO ART139-R AND ART139-E

Less is more: functional TV stand with ability to rotate TV 360°. Image center approx. 100 cm (39.4 inches) Cables are hidden in the column. For 40" to 75" TVs (up to 55 kg; 121 lbs.) with Vesa wall mounts 100 to 400 (also available up to 600).

### FEATURES AND BENEFITS

- > very stable stand
- > high-quality bearings allow stable rotation (TV 90° to the wall)
- > smooth-running soft casters (option)
- > high-quality and sustainable materials ensure maximum quality
- > design and production "Handmade in Germany" with an everlasting lifespan
- > high-quality and durable powder coating
- > hidden cable management (invisible inside the column and base)

### DIMENSIONS (H X W X D)

- > stainless steel column: Diameter 6 cm (2.4 inches)
- > round base: steel painted in matte black with fine texture: Diameter: approx. 60 cm (23.6 inches)
- > square base for size 1: 4 x 68 x 41 cm (1.6 x 26.8 x 16.1 inches)
- > square base for size 2: 4 x 92 x 55 cm (1.6 x 36.2 x 21.7 inches) (for TVs wider than approx. 150 cm/59 inches)
- > for TV installation VESA 100 to 400 (600 mm on request)

### MATERIAL

- > base: powdercoated steel with fine texture in matte black, white, or silvergrey
- > column: Brushed stainless steel
- > feet made of finely brushed stainless steel

### OPTIONS

- > various RAL colors
- > mounts for sound bar or center speaker
- > AV board
- > base as a square or round
- > castors invisibly integrated into stainless steel covers



## TV STAND FRAME ART146

Straight lines and clear visual language for versatile functions: For 40" to 75" TVs (up to 55 kg; 121 lbs.) with Vesa wall mounts 100 to 400 (also available up to 600). Höhe Bildmitte ca. 100 cm.  
 > rotatable over 200°  
 > cables are hidden in the frame, through the turntable, and the base  
 > castors available as an option (invisible in stainless steel covers)

### FEATURES AND BENEFITS

- > very stable stand
- > smooth-running soft castors (option)
- > high-quality and sustainable materials ensure maximum quality
- > design and production "Handmade in Germany" with an everlasting lifespan
- > high-quality and durable powder coating
- > hidden cable management (invisible inside the frame and the base)

### DIMENSIONS (H X W X D)

- > 141 x 90 x 50 cm (55.5 x 35.4 x 19.7 inches)
- > for TV installation VESA 100 to 400 (600 mm on request)

### MATERIAL

- > powder coated steel with fine texture in matte black, white, or silvergrey

### OPTIONS

- > different RAL colors
- > mounts for sound bar or center speaker
- > AV board
- > castors



## TV STAND SWING ART120

This TV holder is a free-standing model with integrated concealed casters.  
Rear-side concealed cable management.  
Height of center of TV screen approx. 100 cm (from floor)

### FEATURES AND BENEFITS

- > very stable stand
- > smooth-running soft casters
- > high-quality and sustainable materials ensure maximum quality
- > design and production "Handmade in Germany" with an everlasting lifespan
- > high-quality and durable powder coating
- > hidden cable management (invisible backside)

### DIMENSIONS (H X W X D)

- > 115 x 52 x 38 cm (for TV screens from 40" to 65", 50 kg)
- > for TV installation VESA 100 to 400 (600 mm on request)

### MATERIAL

- > powdercoated steel with fine textured finish,  
in matt black, white or silvergrey
- > casters in stainless steel covers

### OPTIONS

- > various RAL colors
- > mount for sound bar system or center speaker
- > AV-board



# HIGH-QUALITY AND INDIVIDUAL



## TV STAND ECOLINE OMEGA UND CIRCLE

More is less: Minimalist TV-stand.  
The cable management is concealed within the vertical column.  
Height of center of TV screen approx. 90 cm (from floor)  
Optional TV rotation function  
For TV 40" to 65"

### FEATURES AND BENEFITS

- > very stable stand
- > smooth-running soft casters (option)
- > high-quality and sustainable materials ensure maximum quality
- > "Handmade in Germany" with an everlasting lifespan
- > hidden cable management invisible inside the column

### DIMENSIONS (H X W X D)

- > column: 6 cm
- > base circle: d 53 cm
- > base omega: d 51 cm
- > for TV installation VESA 100 to 400 (600 mm on request)

### MATERIAL

- > stainless steel finely brushed

### OPTIONS

- > AV-board
- > mount for sound bar
- > ball rollers (height: 1,5 cm) or
- > stabile invisible castors in stainless steel cover (height 5 cm)
- > TV rotation function





### CLOCK USE ART185

Bought a new tablet, but still have the old one?

How about downloading a clock app, hang the tablet in the holder, and turn it into a contemporary grandfather clock. Even old tablets can be repurposed this way.

Just choose a clock with hands, a digital clock, or a clock with many words...

#### DIMENSIONS (H X W X D)

- > height to tablet center: 152 cm (59.8 inches)
- > base: 32 x 22 cm (12.6 x 8.7 inches)
- > column 8 x 2 cm (3.1 x 0.8 inches) (hidden cables)

#### MATERIAL

- > powder coated steel with fine texture in matte black, white, or silvergrey

#### OPTIONS

- > various RAL colors
- > height can be customized
- > anti-theft protection



### TABLET STAND FLEX ART183

The new and exclusive tablet stand in minimalist design: easy to assemble, swivels fully, flexible, and very stable.

The selected material combination of brushed stainless steel and finely textured matte surfaces lends the stand a high-end, elegant appearance.

The flexible gooseneck allows the stand to be moved in any direction, remaining stable however positioned.

Perfect for watching movies in bed, working from the comfort of your sofa, or as a music stand. The Flex art183 is usable in many situations.

It makes using a tablet and everyday life in general easier.

Each stand is supplied with two tablet holders which are easily interchangeable and fully rotatable. The solid base ensures stability.

#### DIMENSIONS (H X W X D)

- > gooseneck - Diameter: 1.5 cm (0.59 inches); Length: 60 cm (23.6 inches)
- > base (length x width x height): 32 cm x 22 cm x 1 cm (12.6 x 8.7 x 0.4 inches)
- > height: 115 cm (45.3 inches)
- > weight: 7.5 kg (16.5 lbs.)
- > for all current tablets with screens between 8" and 13"

#### MATERIAL

- > gooseneck: steel black
- > pedestal: Brushed stainless steel
- > base: Steel powdercoated in a matte black with a fine texture

#### OPTIONS

- > pedestal available in different lengths





> flat art142-1



> flat art142-2

## LOUDSPEAKER STAND FLAT ART142

Whether for wall mounting or free-standing: this loudspeaker stand is definitely exceptional. The cables run invisibly behind the column.

### DIMENSIONS (H X W X D)

- > column width 7 cm
- > height 95 cm
- > speaker support 14 x 10 cm

### MATERIAL

- > steel powder-coated in fine structure matt black, white or silvergrey
- > stainless steel front screws

### OPTIONS

- > various RAL colors

> dia art143-2



## LOUDSPEAKER STAND DIA ART143

Minimalistic in high quality and stable.

The cables run in the column.

The stands are universal for different speakers.

We, as producer of the stands, do not know the customer's speaker. This is the reason, why we cannot guarantee the tipping safety. This has to be tested by customer and to be select the right base size (base can be changed by one screw).

### FEATURES AND BENEFITS

- > very stable design
- > high-quality and sustainable materials ensure maximum quality
- > design and production "Handmade in Germany" with an everlasting lifespan
- > high-quality and durable powder coating
- > hidden cable management invisible inside the column

### DIMENSIONS (H X W X D)

- > column diameter 3.5 cm (art143-1 and -2) or 6 cm (143-3, stainless steel)
- > height 100 cm
- > base diameter 23 cm (art143-1 and 143-2)
- > base diameter 29 cm (art143-3)
- > speaker support diameter 10 cm, 11,5 cm or 14 cm

### MATERIAL

- > steel powder-coated in fine structure matt black, white or silvergrey
- > column in stainless steel

### OPTIONS

- > various RAL colors

> dia art143-2



> dia art143-3



> dia art143-2



> dia art143-1



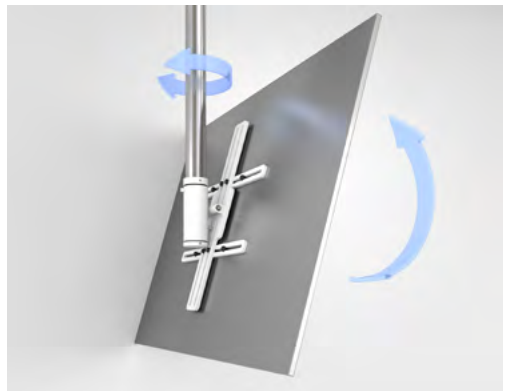

## TV HOLDER CEILING ART116

The minimalist design of art116 provides a maximum degree of functionality. With this holder it is possible to pull the TV into the room, to swivel it into the desired position and tilt it. The anchoring pivotal column also serves to conceal the cable management.  
For TV screens from 40" to 80". (up to 45 kg)

### FEATURES AND BENEFITS

- > high-quality bearings allow stable rotation
- > high-quality and sustainable materials ensure maximum quality
- > design and production "Handmade in Germany" with an everlasting lifespan
- > high-quality and durable powder coating
- > hidden cable management (invisible inside the arm and in the ceiling-box)

### DIMENSIONS (H X W X D)

- > arm length: standard 150 cm
- > recommendation: center of TV screen approx. 100 cm or 39,4" (from floor)
- > min. linear movement 57 cm (different length possible)
- > for TV installation VESA 100 to 400 (600 mm on request)

### MATERIAL

- > painted steel with fine textured finish, in matt black, white or silvergrey
- > column in stainless steel available

### OPTIONS

- > linear movement 57, 137, 207 or 287 cm; special length up to 590 cm possible
- > customized length of vertical arm
- > vertical arm for 360° rotation in stainless steel
- > additional RAL colors
- > mount for sound bar or center speaker
- > AV board
- > reinforcement for TV up to 85 kg



Details at [www.wissmann-raumobjekte.de](http://www.wissmann-raumobjekte.de)